

NOTE:

● Parts marked by " * " are generally unavailable because they are not in our Master Spare Parts List.

● **Parts List(KEH-P4400R/X1M/EW)**

Mark No.	Description	Part No.	Mark No.	Description	Part No.
1	Screw	BSZ26P050FMC	41	Button(SOURCE)	CAC4662
2	Screw	BSZ30P060FMC	42	Button(5,6)	CAC4674
3	Cord Assy	CDE4849	43	Cover	CNS3826
4	Fuse(10A)	CEK1136	44	Grille	CNS3847
5	Case	CNB2010	45	Key Board Unit	CWM4624
6	Holder	CNC5394	46	Pin Jack(CN852)	CKB1028
7	Detach Case	CNS3860	47	Plug(CN603)	CKM1226
8	Detach Grille Assy	CXA8629	48	Connector(CN602)	CKS1730
9	Cassette Mechanism Module	EXK3310	49	Socket(CN902)	CKS2884
10	Screw	CBA1304	50	Connector(CN751)	CKS3408
11	Handle	CNC5395	51	Antenna Jack(CN501)	CKX1006
12	Bush	CNV3930	52	LCD	CAW1343
13	Holder	CNC5704	53	Connector(CN901)	CKS2883
14	Screw	BSZ30P100FMC	54	Holder	CNC6315
15	Insulator	CNM4626	55	Rubber	CNV4363
16	Tuner Amp Unit	CWM4559	56	Connector	CNV4443
17	Chassis Unit	CXA8663	57	Plate	CNV4488
18	Spring	CBH1834	58	Holder	CNC6555
19	Spring	CBH1835	59	Holder	CNC6661
20	Bracket	CNC6135	60	FM/AM Tuner Unit	CWE1416
21	Bracket	CNC6136	61	Screw	BSZ26P140FMC
22	Arm	CNV4358	62	Screw	BSZ26P060FMC
23	Arm	CNV4359	63	Panel	CNB2012
24	Arm	CNV4437	64	Holder	CNC6531
25	Arm	CNV4676	65	Heat Sink	CNR1413
26	Panel Unit	CXA8760	66	Transistor(Q960)	2SD2395
27	Door	CAT1775	67	IC(IC552)	TA8251H
28	Spring	CBH1838	68-71	*****	
29	Screw	PMS20P030FZK	72	Spacer	CNM4911
30	Screw	BPZ20P120FZK	73	*****	
31	Button(△, ◁ ▷)	CAC4594	74	Cushion	CNM4869
32	Button(P.MODE, ITS)	CAC4596	75	Spacer	CNM4920
33	Button(AF, TA, PT)	CAC4604	76	Spacer	CNM4921
34	Button(S)	CAC4605			
35	Button(1,2)	CAC4606			
36	Button(3,4)	CAC4607			
37	Button(DIS, EDIT)	CAC4609			
38	Button(+, -)	CAC4610			
39	Button(◁, ▷)	CAC4611			
40	Button(△)	CAC4817			

- The KEH-P4300R/X1M/EW, KEH-P3300/X1M/EW, KEH-P3400/X1M/IT Parts Lists enumerated the parts which differ from those enumerated in the KEH-P4400R/X1M/EW Parts List only. The parts other than those enumerated in the former are identical with those in the latter, to which you are requested to refer, accordingly. The KEH-P4400R/X1M/EW Parts List is given on page 45.

Mark No. Description	P4400R/X1M/EW	P4300R/X1M/EW	P3300/X1M/EW	P3400/X1M/IT
	Part No.	Part No.	Part No.	Part No.
8 Detach Grille Assy	CXA8629	CXA8475	CXA8630	CXA8631
9 Cassette Mechanism Module	EXK3310	EXK3310	EXK3380	EXK3380
16 Tuner Amp Unit	CWM4559	CWM4559	CWM4626	CWM4626
17 Chassis Unit	CXA8663	CXA8573	CXA8572	CXA8572
26 Panel Unit	CXA8760	CXA8601	CXA8832	CXA8833
31 Button(△, <△>)	CAC4594	CAC4657	CAC4657	CAC4594
32 Button(P.MODE,ITS)	CAC4596	CAC4656	CAC4656	CAC4596
33 Button(AF,TA,PT)	CAC4604	CAC4598	CAC4664	CAC4597
			(CLOCK,RDM,BSM)	(CLOCK,RDM,BSM)
34 Button(S)	CAC4605	CAC4599	CAC4599	CAC4605
35 Button(1,2)	CAC4606	CAC4600	CAC4600	CAC4606
36 Button(3,4)	CAC4607	CAC4601	CAC4601	CAC4607
37 Button(DISP,EDIT)	CAC4609	CAC4603	CAC4603	CAC4609
38 Button(+,-)	CAC4610	CAC4536	CAC4536	CAC4610
39 Button(<△,△>)	CAC4611	CAC4537	CAC4537	CAC4611
40 Button(△)	CAC4817	CAC4816	CAC4816	CAC4817
41 Button(SOURCE)	CAC4662	CAC4595	CAC4595	CAC4662
42 Button(5,6)	CAC4674	CAC4675	CAC4675	CAC4674
43 Cover	CNS3826	CNS3899	CNS3899	CNS3826
44 Grille	CNS3847	CNS3823	CNS3848	CNS3849
45 Key Board Unit	CWM4624	CWM4560	CWM4635	CWM4627
52 LCD	CAW1343	CAW1344	CAW1346	CAW1346

12.2 CASSETTE MECHANISM MODULE

● Parts List

Mark No.	Description	Part No.
1	Screw	BSZ20P040FMC
2	Washer	CBF1037
3	Washer	CBF1038
4	Washer	CBG1003
5	Deck Unit(P4300R,P4400R)	CWM4527
	Deck Unit(P3300,P3400)	CWM4525
6	Screw	EBA1028
7	Screw	EBA1037
8	Spring	EBH1531
9	Spring	EBH1575
10	Cushion	ENM1034
11	Spring	EBH1515
12	Spring	EBH1516
13	Spring	EBH1517
14	Spring	EBH1518
15	Motor	EXM1027
16	Spring	EBH1537
17	Cord	EDD1018
18	Photo-reflector(EGN2,3)	EGN1006
19	Photo-interrupter(EGN1)	EGN1005
20	Roller	ELA1283
21	Shaft	ELA1373
22	Pinch Roller	ENV1468
23	Arm	ENC1396
24	Arm	ENC1397
25	Guide	ENC1398
26	Holder	ENC1417
27	Lever	ENC1418
28	Arm	ENC1401
29	Roller	ENR1027
30	Belt	ENT1027
31	Gear	ENV1347
32	Collar	ENV1349
33	Gear	ENV1350
34	Flywheel	ENV1410

Mark No.	Description	Part No.
35	Worm Gear	ENV1439
36	Worm Wheel	ENV1440
37	Gear	ENR1028
38	Lever	ENV1442
39	Spring	EBH1545
40	P.C.Board	ENP1151
41	P.C.Board	ENP1152
42	Switch(S1)	ESG1004
43	Motor Unit(M2)	EXA1382
44	Motor Unit	EXA1455
45	Pinch Holder	ENV1485
46	Pinch Holder	ENV1486
47	Reel Unit	EXA1456
48	Head Base Unit	EXA1457
49	Lever Unit	EXA1388
50	Gear Unit(P4300R, P4400R)	EXA1389
	Gear Unit(P3300, P3400)	EXA1393
51	Frame Unit	EXA1458
52	Lever Unit	EXA1391
53	Head Assy(HD1) (P4300R,P4400R)	EXA1463
	Head Assy(HD1) (P3300,P3400)	EXA1452
54	Motor Unit(M1)	EXA1381
55	Washer	HBF-179
56	Screw	JGZ20P025FNI
57	Resistor(R1)	RD1/4HM181J
58	Washer	YE20FUC
59	Connector(CN251)	CKS1711
60	Connector(CN252)	CKS2127
61	Connector(CN253)	CKS2129
62	Spare Unit(P4300R, P4400R)	EXA3018
	Spare Unit(P3300, P3400)	EXA3017
63	Spring(P4300R, P4400R)	EBH1519
64	Arm(P4300R, P4400R)	ENV1445
65	Switch(S2)(P4300R, P4400R)	ESG1004

● Cassette Mechanism Module

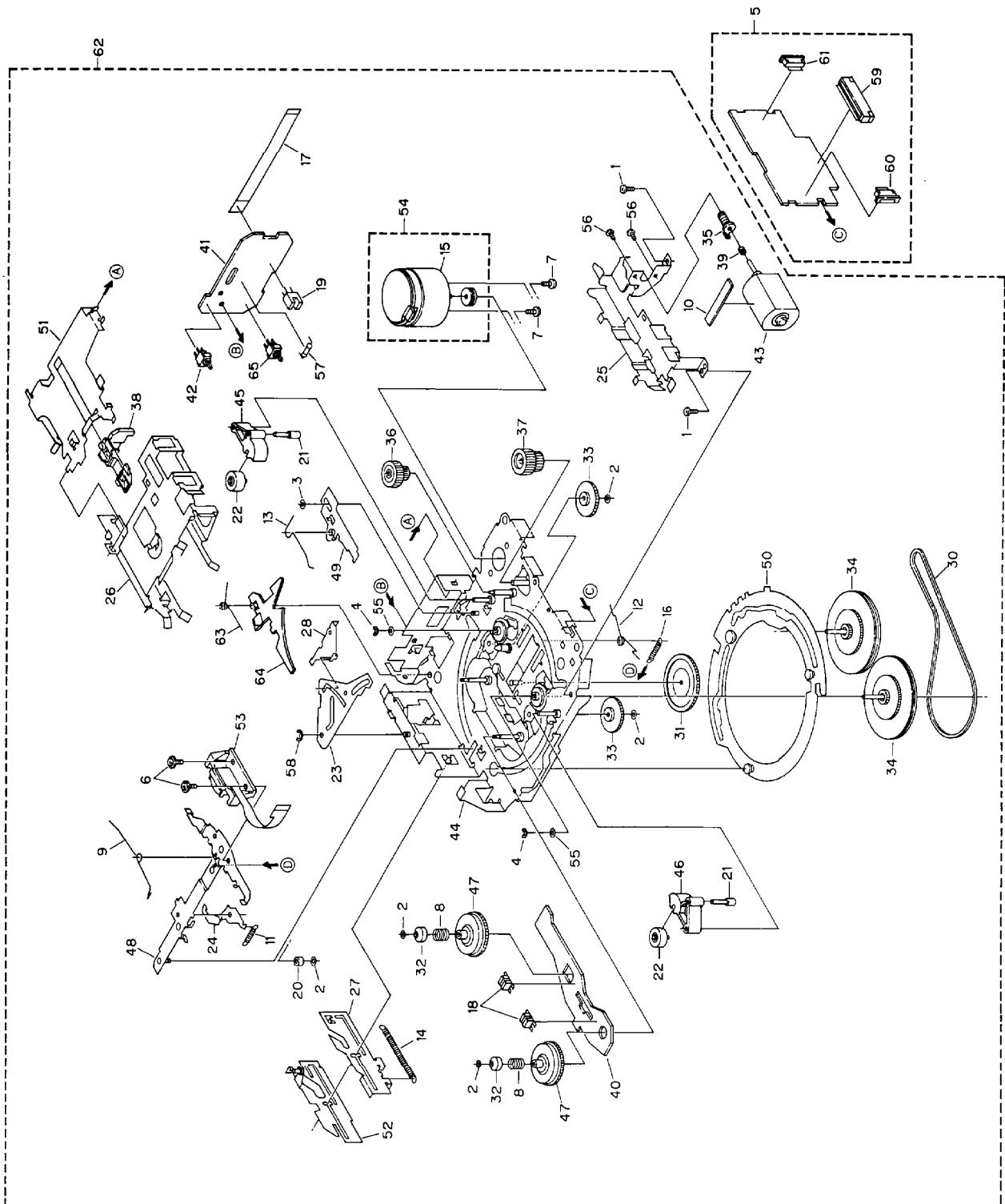

Fig. 20

13. PACKING METHOD

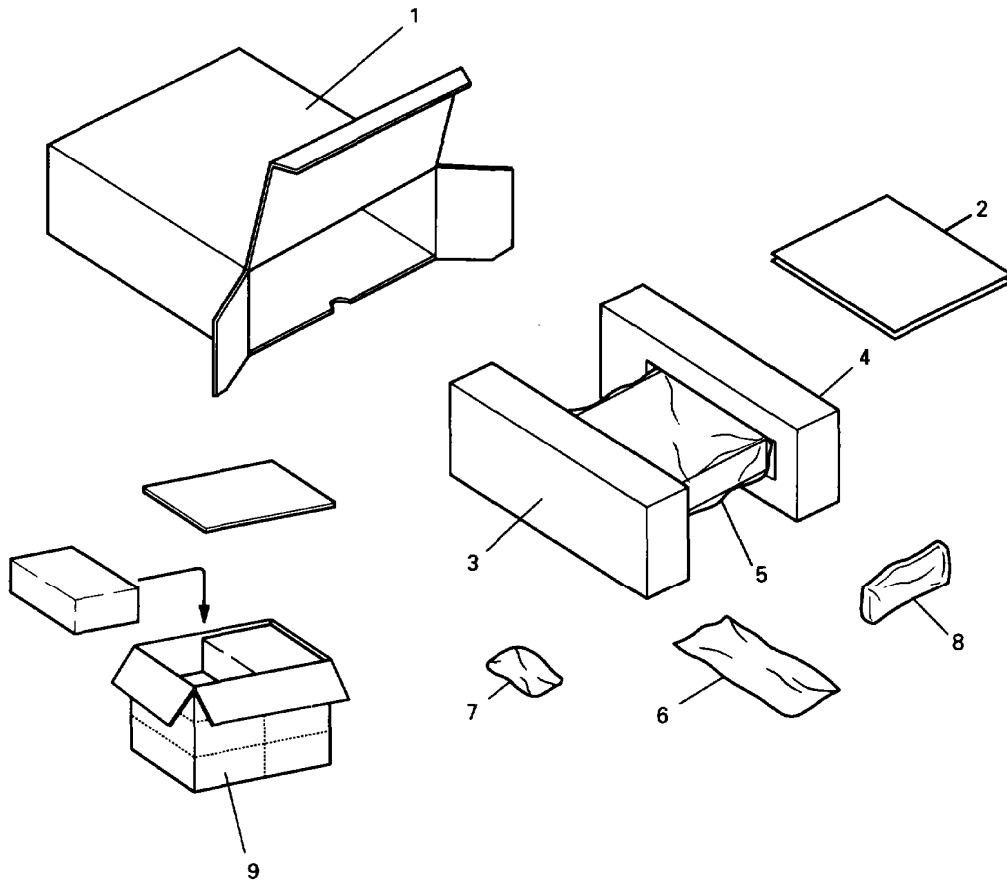

Fig. 21

● Parts List

Mark No.	Description	P4300R/X1M/EW	P4400R/X1M/EW	P3300/X1M/EW	P3400/X1M/IT
		Part No.	Part No.	Part No.	Part No.
1	Carton	CHG2954	CHG2963	CHG2942	CHG2945
2-1	Owner's Manual	CRD1970	CRD1970	CRD2032	CRD2032
2-2	Owner's Manual	CRD1975	CRD1975	CRD2031
* 2-3	Pass Port	CRY1013	CRY1013
* 2-4	Warranty Card	CRY1087	CRY1087	CRY1087	CRY1087
3	Protector	CHP1623	CHP1623	CHP1623	CHP1623
4	Protector	CHP1622	CHP1622	CHP1622	CHP1622
5	Polyethylene Bag	CEG-162	CEG-162	CEG-162	CEG-162
6	Cord Assy	CDE4849	CDE4849	CDE4849	CDE4849
7	Accessory Assy	CEA1917	CEA1917	CEA1917	CEA1917
8	Detach Case	CNS3860	CNS3860	CNS3860	CNS3860
9	Contain Box	CHL2954	CHL2963	CHL2942	CHL2945

* : Non Spare Part

KEH-P4300R,P4400R,P3300,P3400

● Owner's Manual

Model	Part No.	Language
KEH-P4300/X1M/EW	CRD1970	English, Spanish, German
KEH-P4400/X1M/EW	CRD1975	French, Italian, Dutch
KEH-P3300/X1M/EW	CRD2031	English, Spanish, German, French
KEH-P3300/X1M/EW	CRD2032	Italian, Dutch
KEH-P3400/X1M/IT		

● Accessory Assy

Accessory Assy CEA1917

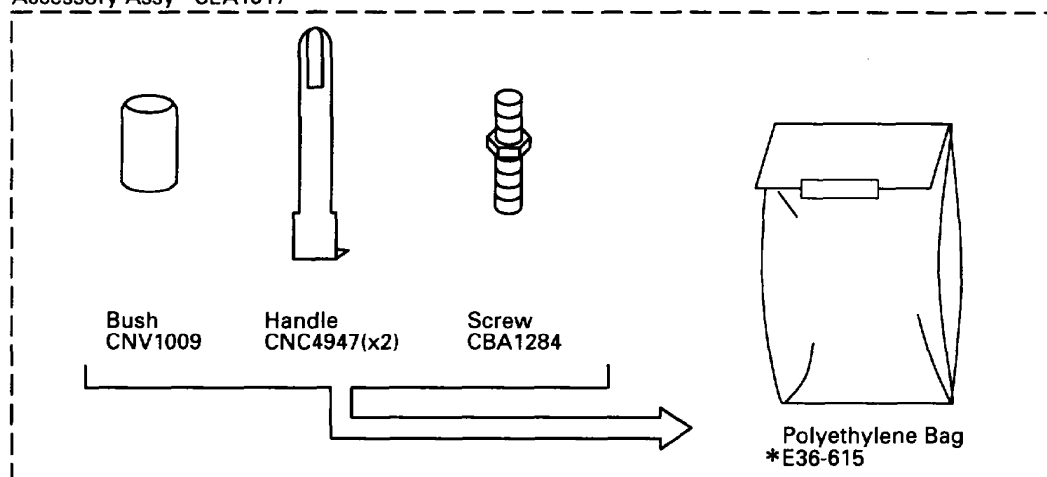

Fig. 22