

13. EXPLODED VIEW AND PARTS LIST

13.1 CHASSIS

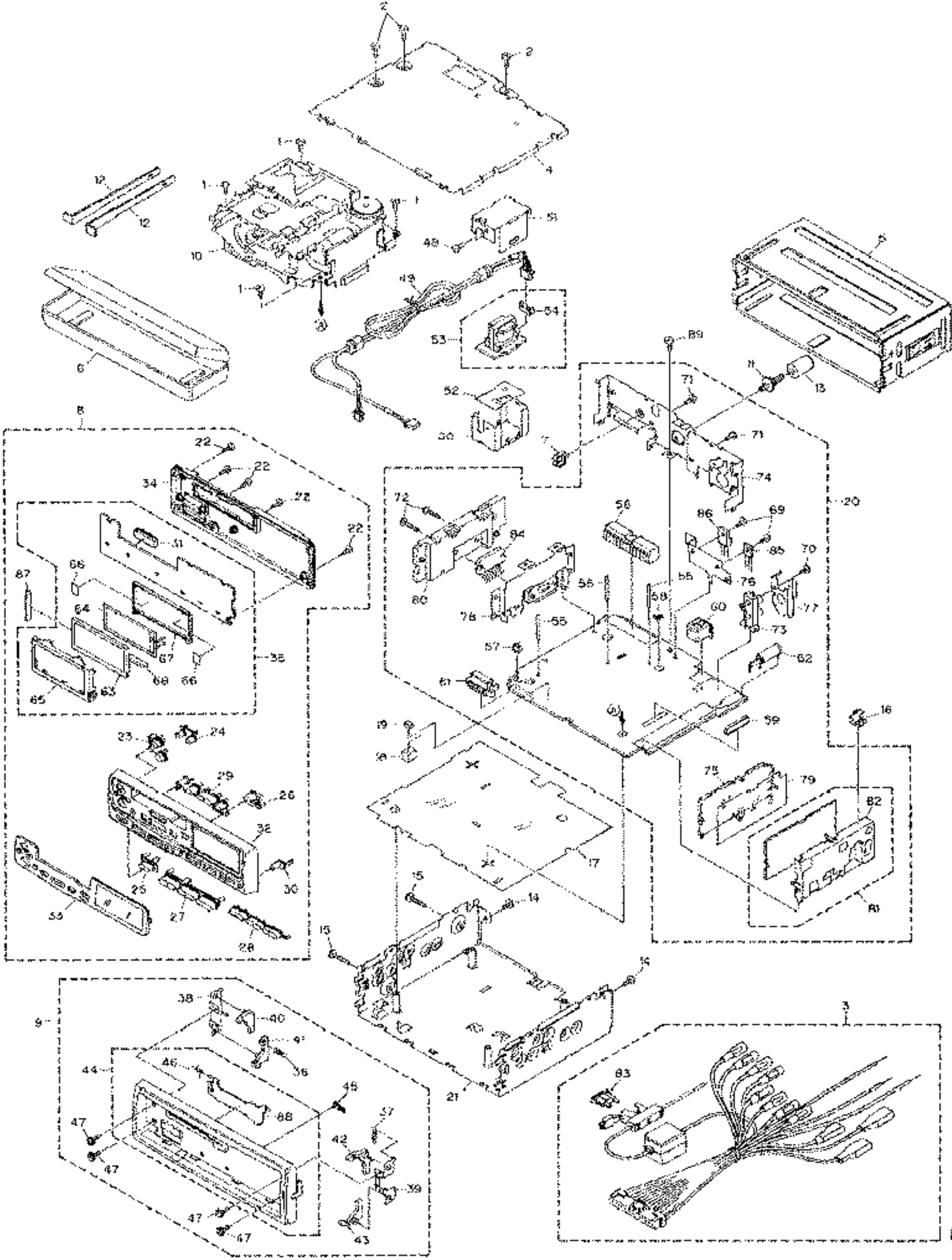

Fig.14

NOTE:

● Parts marked by " \* " are generally unavailable because they are not in our Master Spare Parts List.

● Parts List

Mark No.	Description	Part No.	Mark No.	Description	Part No.
1	Screw	BSZ26P050FMC	46	Spring	CBH1838
2	Screw	BSZ30P050FMC	47	Screw	PMS20P030FZK
3	Cord Assy	CDE4935	48	Screw	BSZ26P050FMC
4	Case	CNB2074	49	Cord	MDE9003
5	Holder	CNC5394	50	Holder	MNC9001
6	Detach Case	CNS3860	51	Holder	MNC9002
7	Clamper	CNV1343	52	Insulator	MNM9001
8	Detach Grille Assy	CXA8665	53	Inverter Unit	MWM9002
9	Panel Assy	CXA8666	54	Plug(CN101)	CKS1224
10	Cassette Mechanism Module	EXK3310	55	Clamper	CEF1005
11	Screw	CBA1304	56	Plug(CN601)	CKM1231
12	Handle	CNC5395	57	Plug(CN641)	CKS1222
13	Bush	CNV3930	58	Plug(CN642)	CKS1235
14	Screw	BSZ30P060FMC	59	Connector(CN671)	CKS1730
15	Screw	BSZ30P100FMC	60	Connector(CN281)	CKS3408
16	Holder	CNC5704	61	Socket(CN643)	CKS3465
17	Insulator	CNM4723	62	Antenna Jack(CN402)	CKX1006
* 18	Spacer	CNM4920	63	LCD	CAW1354
* 19	Spacer	CNM4921	64	EL(CN902)	CEL1465
20	Tuner Amp Unit	CWM4654	65	Holder	CNC6419
21	Chassis Unit	CXA9178	66	Film	CNM4349
22	Screw	BPZ20P100FZK	67	Housing	CNV4533
23	Button(+/-)	CAC4696	68	Connector	CNV4534
24	Button(▶▶)	CAC4688	69	Screw	BMZ26P060FMC
25	Button(SOURCE)	CAC4690	70	Screw	BPZ26P060FMC
26	Button(≡)	CAC4694	71	Screw	BSZ26P050FMC
27	Button(1,2,3,4,5,6)	CAC4696	72	Screw	BSZ26P140FMC
28	Button(7,8,9,10,11,12)	CAC4698	73	Pin Jack(CN351)	CKB1028
29	Button(S,▶▶,AF,TA,F)	CAC4703	74	Panel	CNB2051
30	Button(⊗)	CAC4788	75	Holder	CNC6356
31	Connector(CN901)	CKS2883	76	Holder	CNC6420
32	Grille	CNS3944	77	Holder	CNC6531
33	Plate	CNS3947	78	Holder	CNC6674
34	Cover	CNS3949	79	Insulator	CNM4684
35	Key Board Unit	CWM4655	80	Heat Sink	CNR1426
36	Spring	CBH1834	81	FM/AM Tuner Unit	CWE1416
37	Spring	CBH1835	82	Holder	CNC6555
38	Bracket	CNC6135	83	Fuse(10A)	CEK1136
39	Bracket	CNC6136	84	IC(IC551)	PAL003A
40	Arm	CNV4692	85	Transistor(Q641)	2SD1189
41	Arm	CNV4693	86	Transistor(Q624)	2SD2395
42	Arm	CNV4724	87	Spacer	CNM4955
43	Arm	CNV4695	88	Door	CAT1761
44	Panel Unit	CXA8797	89	Screw	BSZ26P060FMC
45	Clear Plastic Plate	CNV4499			